

# Safe. Reliable. Efficient.

LED lighting solutions for  
industrial applications



A photograph of an industrial facility, likely a power plant or refinery. Large, horizontal, metallic pipes dominate the left side of the frame. In the center and right, there are complex structures of steel beams and scaffolding. Two bright, rectangular LED lighting fixtures are mounted on the structure, casting a strong light. The overall scene is industrial and somewhat dimly lit, with the primary light source being the fixtures.

# Industrial lighting solutions

**Power generation. Food processing. Waste water treatment. Pulp and paper mills.**

**Shipyards and ports.** These are around-the-clock operations where employee safety and zero downtime are critical requirements. You need to maximize your efficiency and minimize the risk of damage to equipment or personnel. You need a partner like Eaton.

Eaton offers a large portfolio of innovative and reliable LED products for non-hazardous, industrial applications. We utilize more than 100 years of lighting expertise to optimize the benefits of LED technology to offer the safest and most reliable LED luminaires on the market today. **These luminaires are engineered to thrive where vibration, corrosion, moisture, dust and extreme temperatures exist.**

With its Crouse-Hinds Series LED luminaires, Eaton can deliver a lighting solution that performs reliably in the worst operating conditions, all the while reducing your energy and maintenance costs.



# Focused on reliability

Products engineered for long life and high lumen performance in harsh and heavy industrial areas



## High Bay LED Lighting

Up to 117 lumens per watt and 67% energy savings over traditional HID fixtures.

The perfect replacement for 250W to 1500W HID and 2-10 lamp fluorescent fixtures.



## LED Floodlighting

Up to 6 times longer life and 65% reduction in power consumption compared to equivalent HID floodlights

8 models available ranging from 3,000 to 50,000 lumens.



## High/Mid Bay LED Lighting

A durable, shock-resistant light source that provides up to 6 times greater life and 53% energy savings over HID.

Available with custom Type I, III and V optics to direct light where customers need it most.



## LED Wallpacks

Uniquely engineered to provide a low profile wall pack solution for industrial lighting applications.

Available from 3,000 to 7,000 lumens and designed for extreme conditions.



## Linear LED Lighting

Engineered to handle demanding conditions.

Stands up to high vibration, hose down, shock and impact, while delivering high lumen output for up to 20 years



## Low Bay/Targeted LED Lighting

85% more energy-efficient than a 200W incandescent and over 200 times the rated life.

Ideal for lower mounting heights, confined spaces, processing areas or utility rooms.

# Industrial High Bay LED Luminaires

IHB series LED luminaires are the perfect replacement for 250W-1,500W+ HID and 2-10 lamp T8, T12 and T5HO fluorescent high bay fixtures. Designed for light industrial locations that:

- require continuous and consistent light levels
- require frequent on-and-off of lights
- are difficult to re-lamp

## Key design features and benefits:

- 5 models ranging from 16,000 to 67,000 lumens replace 250W-1,500W+ HID and 2-10 lamp T8, T12 and T5HO fluorescent
- High efficacy: up to 117 lumens per watt
- 80 CRI
- Up to 67% energy savings over traditional HID fixtures
- Aluminum heat sinks designed to provide long life
- Multiple lens options available: tempered clear glass; diffused glass or diffused polycarbonate
- Versatile mounting options
- Optional 0-10V dimming capabilities
- Damp location rated
- Operating ambient: -40°C to +60°C



Model	Equivalent luminaires		Voltage	@ 120V				
	HID	Fluorescent		PF	THD	Wattage	Lumenst	Efficacy
IHB16L	250-500W	4 lamp T5HO	120	0.99	8%	145	16,900	117
IHB24L	400-750W	4-6 lamp T5HO	120	0.99	7%	216	25,350	117
IHB32L	500-1,000W	6-8 lamp T5HO	120	0.99	8%	289	33,800	117
IHB48L	750-1,500W	8-10 lamp T5HO	120	0.99	8%	436	50,700	116
IHB64L	1,000-1,500W+	10 lamp T5HO	120	0.99	8%	582	67,600	116

†Preliminary typical values (+/- 10%); data subject to change. 8L option available; consult product line for availability.

## Certifications:

- UL1598 Luminaires
- UL8750 LED
- cULus
- Damp location
- DesignLights Consortium® Qualified (some models are not DLC qualified)\*

\* Approved models include: IHB16L/UNV1; IHB16L/UNV34; IHB24L/UNV1; IHB24L/UNV34; IHB32L/UNV1; IHB32L/UNV34; IHB48L/UNV1; IHB48L/UNV34; IHB64L/UNV1; IHB64L/UNV34. Refer to [www.designlights.org](http://www.designlights.org) Qualified Products List under Family Models for full listing details. Not all models are approved for all application categories.



# Industrial High Bay LED Luminaires - Ordering Information

## Part number example

### IHB16LP1R1/UNV1 S903

IHB series high bay LED, 16,900 lumens, 145 watts, cool white, ¾" pendant mount, aisle optics, 100-277 VAC/127-250 VDC driver, polycarbonate lens

IHB		16L		P1		R1		/UNV1		S903	
<b>Series</b>		<b>Mounting</b>		<b>Options</b>		<b>Voltage @ 50/60 Hz</b>		<b>Optics</b>			
<b>IHB</b>		<b>BLANK</b>		<b>BLANK</b>		<b>/UNV1</b>		<b>BLANK</b>			
IHB series light industrial high bay fixture		No mount		Glass lens		100-277 VAC; 127-250 VDC		Wide optic			
<b>Lumens/watts*</b>		<b>P1</b>		<b>S891</b>		<b>/UNV34</b>		<b>S903</b>			
8L**		¾" pendant mount kit (8L-32L models)		Diffused glass lens		347-480 VAC		Polycarbonate lens			
16L		¾" pendant mount kit (48L-64L models)		<b>S903D</b>		<b>/UNV1D</b>		Diffused polycarbonate lens			
16,900 lumens, 145 watts				100-277 VAC; 127-250 VDC		<b>/UNV34D</b>		10 ft. SO cable			
24L											
25,350 lumens, 216 watts											
32L											
33,800 lumens, 289 watts											
48L											
50,700 lumens, 436 watts											
64L											
67,600 lumens, 582 watts											
*Typical values (+/- 10%); data subject to change.											
**8L option available; consult product line for availability.											
<b>Color temperature</b>											
<b>BLANK</b>											
Cool white											

#### Mounting kits (ordered separately)

<b>IHBP1 KIT</b>	¾" pendant mount kit (8L-32L models)
<b>IHBP2 KIT</b>	¾" pendant mount kit (48L-64L models)
<b>IHBJ1 KIT</b>	48" jack chain kit
<b>IHBJ2 KIT</b>	72" jack chain kit
<b>IHBJ3 KIT</b>	96" jack chain kit
<b>IHBJ4 KIT</b>	120" jack chain kit
<b>IHBJ5 KIT</b>	144" jack chain kit
<b>IHBA1 KIT</b>	40" aircraft cable kit
<b>IHBA2 KIT</b>	80" aircraft cable kit
<b>IHBA3 KIT</b>	120" aircraft cable kit
<b>IHBA4 KIT</b>	180" aircraft cable kit

#### Replacement drivers (ordered separately)

100-277 VAC; 127-250 VDC	
<b>IHB UNV1D 75W DRIVER KIT*</b>	Dimmable, 75W replacement driver
<b>IHB UNV1D 150W DRIVER KIT**</b>	Dimmable, 150W replacement driver
*8L and 24L models; **16L, 24L, 32L, 48L and 64L models. (24L model uses a single 75W and a single 150W driver)	
347-480 VAC	
<b>IHB UNV34D 75W DRIVER KIT*</b>	Dimmable, 75W replacement driver
<b>IHB UNV34D 150W DRIVER KIT**</b>	Dimmable, 150W replacement driver
*8L and 24L models; **16L, 24L, 32L, 48L and 64L models. (24L model uses a single 75W and a single 150W driver)	

## Mounting options:

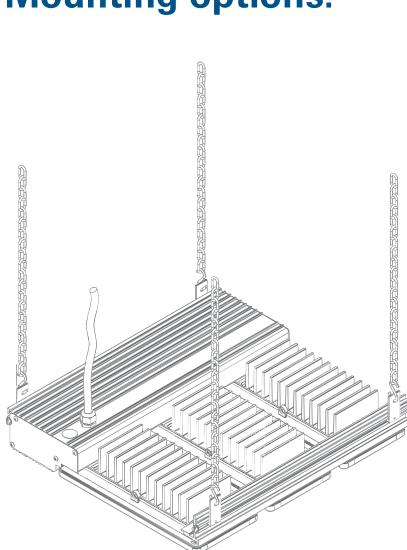

Jack chain

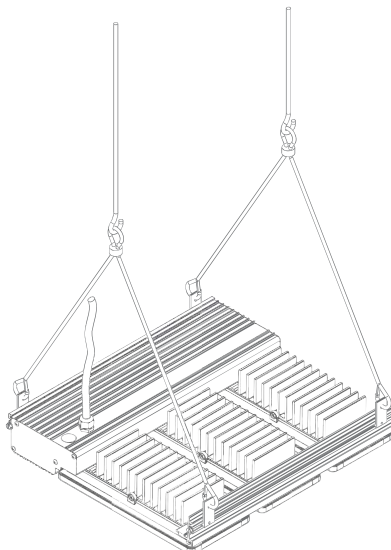

Aircraft cable

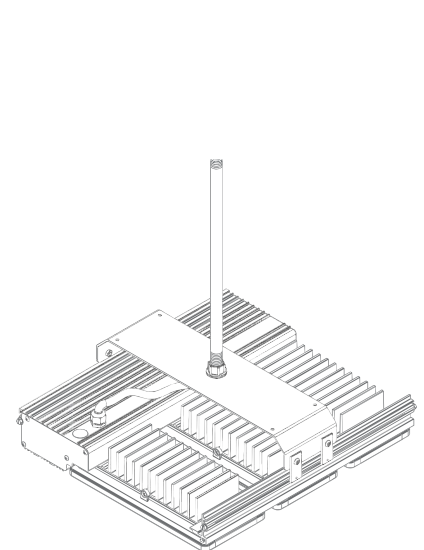

Pendant mount

# Champ® Pro PFMA Series LED Floodlights

Champ Pro PFMA LED floodlights are designed to provide full-spectrum, crisp, white light. With eleven versions available from 3,000 to 50,000 lumens, the Champ Pro PFMA floodlight provides years of high quality lighting and maintenance-free performance.

- Ideal for indoor and outdoor wall or pole mounted area lighting in manufacturing plants, mine sites, processing areas, platforms, loading docks and parking areas

## Key design features and benefits:

- Reduced footprint - **Now 25% smaller footprint and 10-20 lbs. lighter than previous models.**
- High efficiency LEDs and drivers provide up to 144 lumens per watt
- Up to 78% reduction in energy used versus equivalent HID fixtures
- Engineered for long life in extreme ambients. 3L-15L models rated for 60,000 hours in -40°C to 65°C ambients. 20L-50L models rated 60,000 hours in -40°C to 55°C ambients
- 7x6 and 3x3 floodlight pattern options provides maximum light distribution
- Full frame yoke utilizes the SFA6 slipfitter and SWB6 wall mount bracket (3L-25L models), making it ideal for retrofit or new installations
- Options include diffused glass or polycarbonate lens, bolt-on wire guard, bolt-on visor and slipfitter mounting adapters

Model	Nominal lumens	Wattage*	Lumens per watt	Equivalent HID luminaire
PFMA3L	3,312	26	129	70W
PFMA5L	5,381	40	133	100W
PFMA7L	7,274	55	132	175W
PFMA9L	9,479	67	142	250W
PFMA11L	11,776	82	144	320W
PFMA13L	13,362	93	143	400W
PFMA15L	15,183	108	140	500W
PFMA20L	20,500	175	117	600W-750W
PFMA25L	25,500	216	118	750W-1000W
PFMA40L	40,500	340	119	1500W+
PFMA50L	50,500	411	123	1500W+

\* UNV1 at 120 VAC.



## Certifications:

NEC and CEC:

- Wet Locations, Type 4X, IP66

UL Standards:

- UL8750 (PFM3L-PFM15L only); UL1598; UL1598A
- cUL Listed to CSA Standard CSA C22.2 No. 250

IEC Standards:

- IEC 60598
- CE

(nPFM20L-nPFM50L only):

- IEC 60598-1 and IEC 60598-2-1
- Wet Locations, IP66
- CE marked





# Champ® Pro PFMA LED Floodlights - Ordering information

## Part number example

**PFMA7LCY-UNV1-76-M20-S891-BZ**

Champ PFMA floodlight, 7,274 lumens, cool white, yoke mount, 100-277 VAC driver, 20mm entry, diffused glass lens, bronze paint

# PFMA 7L C Y - UNV1 - 76 - M20 - S891 - BZ

For 20L-50L IEC models, change to nPFMA

### Light source/intensity

<b>3L</b>	3,312 nominal lumens*
<b>5L</b>	5,381 nominal lumens*
<b>7L</b>	7,274 nominal lumens*
<b>9L</b>	9,479 nominal lumens*
<b>11L</b>	11,776 nominal lumens*
<b>13L</b>	13,362 nominal lumens*
<b>15L</b>	15,183 nominal lumens*
<b>20L</b>	20,500 nominal lumens*
<b>25L</b>	25,500 nominal lumens*
<b>40L</b>	40,500 nominal lumens*
<b>50L</b>	50,500 nominal lumens*

\*7x6 model

### Color temperature

<b>C</b>	5000K, 70 CRI (cool white)
<b>W</b>	3000K, 70 CRI (warm white)

### Mount

<b>Y</b>	Yoke
----------	------

### Accessories (ordered separately)

<b>BLHN</b>	Bull horn, 1 tenon, gray
<b>BLHN-BZ</b>	Bull horn, 1 tenon, bronze
<b>BLHN-WH</b>	Bull horn, 1 tenon, white
<b>BLHN2</b>	Bull horn, 2 tenon, gray
<b>BLHN-BZ2</b>	Bull horn, 2 tenon, bronze
<b>BLHN-WH2</b>	Bull horn, 2 tenon, white
<b>BLHN3</b>	Bull horn, 3 tenon, gray
<b>BLHN-BZ3</b>	Bull horn, 3 tenon, bronze
<b>BLHN-WH3</b>	Bull horn, 3 tenon, white
<b>DSV2</b>	Bolt-on visor
<b>P62</b>	Bolt-on wire guard
<b>SC831</b>	Safety cable
<b>SFA6*</b>	Slipfitter
<b>SWB6*</b>	Slipfitter wall mount

\*3L-25L models only.

### Voltage†

<b>UNV1*</b>	100 - 277 VAC, 50/60 Hz; 127 - 250 VDC
<b>UNV34**</b>	347-480 VAC, 50/60 Hz

† For 20L-50L models, change to /UNV1 and /UNV34

\*IEC voltage; 100-240V @ 50/60 Hz

\*\*Available for PFMA5L-50L only

### Optical distribution

<b>76</b>	7x6 floodlight pattern optics
<b>33</b>	3x3 floodlight pattern optics

### Entries

<b>BLANK</b>	¾" NPT
<b>M20</b>	20mm
<b>M25</b>	25mm

### Paint

<b>BLANK</b>	Gray
<b>BZ</b>	Bronze
<b>WH</b>	White

### Lens material

<b>BLANK</b>	Clear glass lens
<b>S891</b>	Diffused glass lens
<b>S903*</b>	Polycarbonate lens

\*3L-15L models only



# Champ® Pro PVML Series LED Luminaires

Champ® Pro PVML luminaires are designed to provide full-spectrum, crisp, white light with custom Type I, III and V distribution. Nine versions of the PVML series are available, providing ideal solutions for a wide range of heavy industrial, non-hazardous applications, including:

- areas with mounting heights from 8 feet up to 60 feet
- Type 4X, marine, wet locations and hose-down environments
- locations requiring continuous and consistent light levels in extreme ambient temperatures

## Key design features and benefits:

- Rated life of 60,000 hours @ 55°C operating ambient and 24/7 continuous operation for 365 days. Economic life of 170,000 hours @ 25°C ambient
- Die cast aluminum heat sink increases surface areas and improves airflow, optimizing both LED and driver life
- Custom Type V, Type III and Type I optics distribute the light where it is needed most and can help reduce the number of fixtures required for certain lighting applications
- Cool white standard (5000K, 70 CRI); warm white (3000K, 80 CRI) and neutral white (4000K, 70 CRI) optional
- Energy-efficient technology - up to 77% energy savings over HID fixtures
- Operating ambient: -40°C to 65°C (PVM3L-PVM11L models); -40°C to 55°C (PVM13L-PVM25L models)
- High efficiency drivers provide reliable operation in the harshest environments. Various AC and DC input voltage options are available to suit virtually any drive requirement
- Option for redundancy in drivers with multiple series circuits connected to each driver to avoid complete loss of illumination
- Provided with lever lock connectors and standard three-pole terminal block for easy installation
- Contractor-friendly PVML LED utilizes the same mounting modules as our legacy HID luminaires, simplifying installation and reducing costs in retrofit projects



## Certifications:

- DesignLights Consortium® Qualified (some models are not DLC qualified)\*

## NEC and CEC

- Wet Locations, Type 4X, IP66

## UL Standards

- UL1598 Luminaires, UL1598A Marine

## CSA Standard

- cUL Listed to CSA Standard CSA C22.2 No. 250

## IEC Standard

- CE

\* Refer to [www.designlights.org](http://www.designlights.org) Qualified Products List under family models for full listing details. Not all models are approved for all application categories.

Model	Typical lumens (Type V)*	Wattage	Lumens per watt	Equivalent HID luminaire	Typical energy savings / lifetime
PVML-3	3,250	26	123	70W	Up to 77%
PVML-5	5,537	43	127	100W	Up to 67%
PVML-7	7,442	59	127	175W	Up to 67%
PVML-9	9,234	73	126	250W	Up to 74%
PVML-11	11,114	91	122	320W	Up to 74%
PVM13L	13,226	130	102	400W	Up to 68%
PVM17L	18,793	168	112	400-600W	Up to 72%
PVM21L	22,110	196	113	600-750W	Up to 74%
PVM25L	26,531	232	114	750-1000W	Up to 77%

\* Tolerance +/- 10%.





# Champ® Pro PVML LED Luminaires - Ordering information 3L-11L

## Part number example

### PVML-3-N-2A-R1-G-UNV1-S831-S891

Champ PVML, 3,000 lumens, 4000K neutral white, ¾" pendant mount, Type I optics, wire guard, 100-277 VAC driver, safety cable, diffused glass lens

## PVML - 3 - N - 2A - R1 - G - UNV1 - S831 - S891

### Light source/intensity†

<b>3</b>	3,250 nominal lumens
<b>5</b>	5,537 nominal lumens
<b>7</b>	7,442 nominal lumens
<b>9</b>	9,234 nominal lumens
<b>11</b>	11,114 nominal lumens

†Refer to Champ PVM ordering information on page 11 for 13,000 to 25,000 lumen models.

### Color temperature\*\*

<b>BLANK</b>	5000K, 70 CRI (cool white)
<b>N*</b>	4000K, 70 CRI (neutral white)
<b>W</b>	3000K, 80 CRI (warm white)

\*Consult factory for lead time.  
\*\*5700K and 6500K are available upon request; consult factory.

### Lens guard

<b>BLANK</b>	No guard
<b>G</b>	Wire guard

### Optics

<b>BLANK</b>	Type V optic standard
<b>R1</b>	Type I optic
<b>R3</b>	Type III optic (all mounts minus ceiling)
<b>R3AP*</b>	Type III optic (select when using Appleton® top hat adapter with Champ fixture)
<b>R3A1*</b>	Type III optic (ceiling with conduit 45° counterclockwise from top hat hinge)
<b>R3A2*</b>	Type III optic (ceiling with conduit 135° clockwise from top hat hinge)
<b>R3B1*</b>	Type III optic (ceiling with conduit 45° clockwise from top hat hinge)
<b>R3B2*</b>	Type III optic (ceiling with conduit 135° counterclockwise from top hat hinge)

\*Available with ceiling mount modules only.

### Accessories & option†

<b>S812</b>	Trunnion mount kit with pin (available with ceiling mount only)
<b>S831</b>	Safety cable
<b>S890</b>	Quick clip
<b>S933</b>	80 CRI minimum (4000K & 5000K only)
<b>TB6*</b>	Six-pole terminal block

†Ordered with fixture or available separately.  
\*For NEC/CEC only.

### Voltage

<b>UNV1</b>	100-277 VAC, 50/60 Hz; 127-250 VDC
<b>UNV34</b>	347-480 VAC, 50/60 Hz

IEC voltage; 100-240VAC @ 50/60 Hz

### Mounting

<b>BLANK</b>	No mounting module
<b>J</b>	1-½" stanchion, 25° angled
<b>P</b>	1-½" stanchion, straight
<b>2A</b>	¾" pendant
<b>3A</b>	1" pendant
<b>20A</b>	20mm pendant

<b>25A</b>	25mm pendant
<b>2B</b>	¾" cone pendant
<b>3B</b>	1" cone pendant
<b>2HA</b>	¾" flexible pendant
<b>2C</b>	¾" ceiling
<b>3C</b>	1" ceiling

<b>20C</b>	20mm ceiling
<b>25C</b>	25mm ceiling
<b>2TW</b>	¾" wall
<b>3TW</b>	1" wall
<b>20TW</b>	20mm wall
<b>25TW</b>	25mm wall

### Lens material

<b>BLANK</b>	Clear glass
<b>S891</b>	Diffused glass
<b>S896*</b>	Teflon coated lens
<b>S903</b>	Clear polycarbonate

\*NEC/CEC only.

### Custom optics:

Three optical options to maximize light distribution and intensity:



Type I



Type III



Type V

#### TYPE I

Long and rectangular.

- Conveyor belts
- Hallways, aiseways, catwalks and walkways
- Ramps and loading docks
- Tunnels with overhead mounts

#### TYPE III

Wall mount light distribution, minimizing spillover.

- Narrow crosswalks or passages with wall mounted fixtures
- Tunnels with wall mount
- Wall or stanchion mount requiring 180° forward throw beam patterns

#### TYPE V

Regular circular distribution pattern.

- Pendant, ceiling or stanchion mount overhead building mounts
- Processing mills, industrial plants, large buildings, warehouses, etc.

# Champ® Pro PVML LED Luminaires - Ordering information 13L-25L

## Part number example PVM17LW2AR1G/UNV1 S890

Champ PVM, 18,793 lumens, 3000K warm white, ¾" pendant mount, Type I optics, wire guard, 100-277 VAC driver, safety cable, diffused glass lens

**Lamp/function**

13L	13,226 lumen LED
17L	18,793 lumen LED
21L	22,110 lumen LED
25L	26,531 lumen LED
GL*	Green (4,300 lumen LED)
AL*	Amber (5,000 lumen LED)

\*Custom optics not available with colored LEDs.

**Color temperature\***

BLANK	Cool (5000K) or colored
N	Neutral (4000K)
W	Warm (3000K)

\*Consult with factory for additional color temperature options.

**Mounting style**

BLANK	No cover
P	1-½" stanchion, straight
2A	¾" pendant
3A	1" pendant
20A	20mm pendant
25A	25mm pendant
2B	¾" cone pendant
3B	1" cone pendant

**Suffixes**

S812*	Trunnion mount kit with pin
S831	Safety cable
S890	Quick clip
S891	Diffused lens
S896	Teflon coated lens
S903	Polycarbonate lens
TB6	Six-pole terminal block

\*Order with ceiling mount only.

**Voltage**

/UNV1	120-277 VAC, 50/60 Hz; 108-250 VDC, 50/60 Hz
/UNV34	347-480 VAC, 50/60 Hz

**Guard**

BLANK	No guard
G	Wire guard (3L-11L)

**Optics**

BLANK	Type V optic standard
R1	Type I optic
R3	Type III optic (all mounts minus ceiling)



Type I



Type III



Type V

**TYPE I** 

Long and rectangular.

- Conveyor belts
- Hallways, aisleways, catwalks and walkways
- Ramps and loading docks
- Tunnels with overhead mounts

**TYPE III** 

Wall mount light distribution, minimizing spillover.

- Narrow crosswalks or passages with wall mounted fixtures
- Tunnels with wall mount
- Wall or stanchion mount requiring 180° forward throw beam patterns

**TYPE V** 

Regular circular distribution pattern.

- Pendant, ceiling or stanchion mount overhead building mounts
- Processing mills, industrial plants, large buildings, warehouses, etc.

### Custom optics:

Three optical options to maximize light distribution and intensity:

Type I

Type III

Type V

### TYPE I

Long and rectangular.

- Conveyor belts
- Hallways, aisleways, catwalks and walkways
- Ramps and loading docks
- Tunnels with overhead mounts

### TYPE III

Wall mount light distribution, minimizing spillover.

- Narrow crosswalks or passages with wall mounted fixtures
- Tunnels with wall mount
- Wall or stanchion mount requiring 180° forward throw beam patterns

### TYPE V

Regular circular distribution pattern.

- Pendant, ceiling or stanchion mount overhead building mounts
- Processing mills, industrial plants, large buildings, warehouses, etc.

10

EATON'S CROUSE-HINDS SERIES

# Champ® Pro PVML LED Luminaires - Accessories

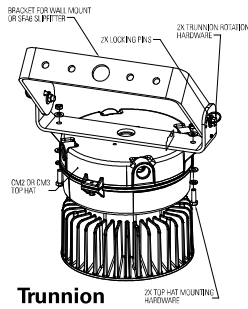

## Mounting & hardware

<b>VMVL S812 K1*</b>	Trunnion mount kit with pin
<b>VMVL S831 K1</b>	Safety cable
<b>VMVL S890 K1</b>	Quick clip
<b>CHMM1</b>	Top hat adapter (mounts to Appleton Mercmaster III top hats)
<b>347/480 K1</b>	Step down transformer for 347-480 VAC applications

\* Available with ceiling mounted modules only

## Replacement driver kit

<b>VMVL-3-5-7L-UNV1-DRIVER KIT</b>	Replacement driver kit for PVML-3, -5 and -7 models
<b>VMVL-9-11L-UNV1-DRIVER KIT</b>	Replacement driver kit for PVML-9 and -11 models

## Photocells

<b>D2S20</b>	Photocell, 120V
<b>D2S208 277</b>	Photocell, 208-277V

## Lens guard

<b>P3001</b>	Wire guard (3L-11L)
<b>P3002</b>	Wire guard (13L-25L)

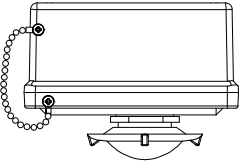

## Occupancy sensors

<b>ORDC/UNV1</b>	3/4" NPT entry, 100-277 VAC
------------------	-----------------------------

## Occupancy sensor accessories (ordered separately)

<b>CABLE KIT ORD 1</b>	TECK armored cable (5ft) with TECK glands (3/4")
<b>CABLE KIT ORD 2</b>	P Type non armored cable (5ft) with ADE1F glands (3/4")
<b>CABLE KIT ORD 3</b>	Metal-clad armored cable (5ft) with TMC glands (3/4")
<b>CABLE KIT ORD 4</b>	SO cable (5ft) with ADE1F glands (3/4")
<b>ORDC WKIT</b>	Wall mount kit
<b>ORDC PKIT</b>	Pendant mount kit
<b>ORDC SKIT</b>	Stanchion mount kit
<b>REMOTE CONTROL 1</b>	Remote control for programming sensor

## Mounting options and dimensions:

### Stanchion - 25° angled

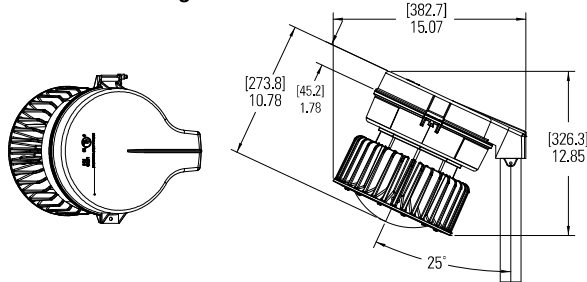

### Stanchion - straight

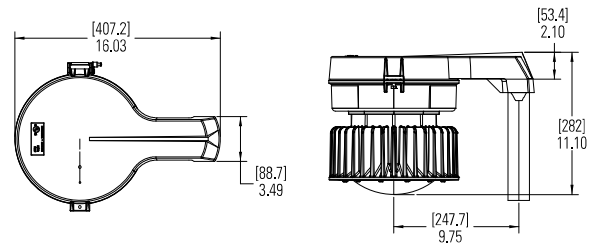

### Pendant

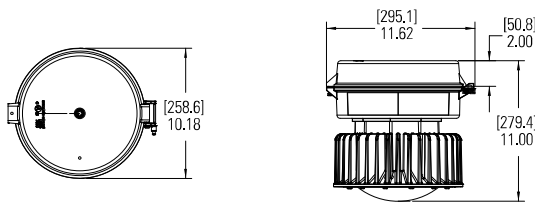

### Ceiling

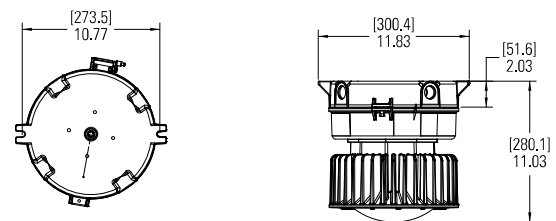

### Wall

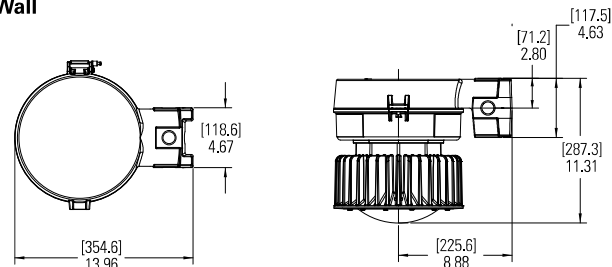

### Cone pendant

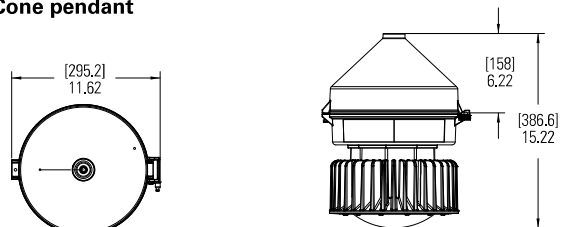



# Champ® Pro PVMA Series LED Luminaires

The Champ Pro PVMA LED features a compact, high efficacy design with custom Type I, III and V optics to ensure maximum efficiency and mounting flexibility. The compact and lightweight PVMA LED is available in 5,000 and 7,500 lumen models.

- Performs reliably in medium or heavy duty industrial environments where extreme ambient temperatures, corrosive, wet, dusty conditions or significant vibration are common
- Mining, marine, food & beverage, wood, pulp & paper, pharmaceutical, livestock, wastewater, steel, power generation, chemical, automotive, aviation, aerospace and general industrial manufacturing

## Key design features and benefits:

- Rugged design – engineered for durability in complex environments
- High efficiency – up to 122 lumens per watt and custom optics to maximize light on the work plane
- Ease of installation – compact footprint with ceiling, pendant, wall or stanchion mount options and the ability to retrofit Crouse-Hinds installed base
- Temperature rating: -40°C to 55°C
- 5-year fixture warranty - refer to the authorized distributor price book for Crouse-Hinds standard terms and conditions

Model	Typical lumens *	Wattage	Lumens per watt	Equivalent HID luminaire	Typical energy savings / lifetime
PVMA5L	5,884	48	122	150W	Up to 67%
PVMA7.5L	7,766	64	122	175W	Up to 67%

\* Nominal lumens based on Type V optics, 5000K CCT with clear glass lens.  
Wattage measured at 120 VAC.



## Certifications:

- DesignLights Consortium® Qualified
- IP66
- RoHS

### UL Standards

- UL1598, UL1598A

### CSA Standards

- C22.2 No. 250

### IEC Standard

- CE
- IEC 60598



# Champ® Pro PVMA LED Luminaires - Ordering information

## Part number example

**PMVA5LW2CR1G/UNV1 S831 S891**

Champ Pro PVMA, 5,800 lumens, 3000K warm white, ¾" ceiling mount, Type I optics, wire guard, 120-277 VAC driver, safety cable, diffused glass lens

PVMA		5L		W		2C		R1		G		/UNV1		S831		S891	
<b>Light source/intensity</b>										<b>Lens guard</b>		<b>Voltage</b>				<b>Lens material</b>	
<b>5L</b> 5,800 nominal lumens										<b>BLANK</b> No guard		<b>/UNV1</b> 120-277 VAC, 50/60 Hz; 127-300 VDC				<b>BLANK</b> Clear glass	
<b>7.5L</b> 7,700 nominal lumens										<b>G</b> Wire guard		<b>/UNV34</b> 347–480 VAC, 60 Hz				<b>S891</b> Diffused glass	
																<b>S903</b> Polycarbonate	
																<b>S903D</b> Diffused polycarbonate	
<b>Color temperature*</b>										<b>Optics</b>						<b>Accessories*</b>	
<b>A</b> 5000K, 70 CRI (cool white)										<b>BLANK</b> Type V optic standard						<b>S812</b> Trunnion mount kit with pin	
										<b>R1</b> Type I optic						<b>S831</b> Safety cable	
										<b>R3</b> Type III optic (all mounts minus ceiling)						<b>S890</b> Quick clip	
										<b>R3AP*</b> Type III optic (select when using Appleton® top hat adapter with Champ fixture)						Ordered with fixture or available separately.	
										<b>R3A1*</b> Type III optic (ceiling with conduit 45° counterclockwise from top hat hinge)							
										<b>R3A2*</b> Type III optic (ceiling with conduit 135° clockwise from top hat hinge)							
										<b>R3B1*</b> Type III optic (ceiling with conduit 45° clockwise from top hat hinge)							
										<b>R3B2*</b> Type III optic (ceiling with conduit 135° counterclockwise from top hat hinge)							
<b>BLANK</b> No mounting module				<b>3A</b> 1" pendant				<b>3B</b> 1" cone pendant				<b>20C</b> 20mm ceiling				<b>20TW</b> 20mm wall	
<b>J</b> 1-½" stanchion, 25° angled				<b>20A</b> 20mm pendant				<b>2HA</b> ¾" flexible pendant				<b>25C</b> 25mm ceiling				<b>25TW</b> 25mm wall	
<b>P</b> 1-½" stanchion, straight				<b>25A</b> 25mm pendant				<b>2C</b> ¾" ceiling				<b>2TW</b> ¾" wall					
<b>2A</b> ¾" pendant				<b>2B</b> 2-¾" cone pendant				<b>3C</b> 1" ceiling				<b>3TW</b> 1" wall					

## Accessories (ordered separately)

### Replacement driver kits

<b>PVMA5L/UNV1 DRIVER KIT</b>	Replacement driver kit for UNV1 driver (120-277 VAC, 50/60 Hz; 127-300 VDC)	<b>PVMA7.5L/UNV1 DRIVER KIT</b>	Replacement driver kit for UNV1 driver (120-277 VAC, 50/60 Hz; 127-300 VDC)
<b>PVMA5L/UNV34 DRIVER KIT</b>	Replacement driver kit for UNV34 driver (347-480 VAC, 60 Hz)	<b>PVMA7.5L/UNV34 DRIVER KIT</b>	Replacement driver kit for UNV34 driver (347-480 VAC, 60 Hz)

### Mounting & hardware

<b>VMVL S812 K1</b>	Trunnion mount kit with pin	<b>VMVL S831 K1</b>	Safety cable	<b>VMVL S890 K1</b>	Quick clip	<b>Lens guard</b>	
						<b>PA3001</b>	Wire guard

# Champ-Pak WPMV Series LED Wallpacks

The Crouse-Hinds series Champ-Pak WPMV is uniquely engineered to provide a low profile wall pack solution for industrial lighting applications. It's the ideal choice for vertical surface lighting where conditions require high quality, reliable illumination.

Champ-Pak WPMV LED wall packs are engineered to provide maintenance free illumination, long life and high performance in industrial areas. It is available from 3,000 to 7,000 lumens and is designed for extreme conditions.

- Heavy industrial, mine site processing areas, platforms, loading docks, tunnels, outdoor wall and areas requiring frequent on-and-off of lights

## Key design features and benefits:

- Rated life of 60,000 hours @ 55°C operating ambient and 24/7 continuous operation for 365 days. Economic life of 170,000 hours @ 25°C ambient
- Impact-resistant lens sealed from the outside environment provides ingress protection against water and dust
- High efficiency: Up to 116 lumens per watt
- Engineered to perform in ambient temperatures from -40°C to +55°C
- Die cast aluminum LED housing provides efficient thermal path to heat sink assembly
- Vertical fin design facilitates air flow and dust shedding
- Multiple lens options: Clear glass lens standard. Optional lenses include diffused glass, clear polycarbonate and diffused polycarbonate
- Narrow & wide optics available for ideal light output and performance
- Factory-installed photocell available
- Wall, yoke and hub mount options for installation flexibility and optimal aiming
- Available with lever lock connectors for simple installation
- Contractor-friendly design is ideal for both retrofit and new construction
- 5-year fixture warranty - refer to the authorized distributor price book for Crouse-Hinds standard terms and conditions

Model	Typical lumens *	Wattage	Lumens per watt	Equivalent MH luminaire	Typical energy savings / lifetime
WPMV3L	3,400	30.6	111	70W	
WPMV5L	5,200	44.8	116	100W	Up to 70%
WPMV7L	6,800	58.9	115	150W-175W	

\*Nominal lumens based on 5000K CCT with clear glass lens.  
Wattage measured at 120 VAC.



## Certifications:

- DesignLights Consortium® Qualified (pending)

## NEC and CEC

- Marine and Wet Locations, NEMA 4X, IP66

## UL Standards

- UL1598 Luminaires, UL1598A Marine, UL8750

## CSA Standard

- CSA C22.2 No. 250



mid bay/low bay



# Champ-Pak WPMV LED Wallpacks - Ordering information

## Part number example

### WPMV3LWY-UNV1-S891 PC1

Champ-Pack WPMV LED wall pack, NEC/CEC rated, 3,400 lumens, 3000K warm white, wide optic, yoke mount, 120-277 VAC, diffused glass window, 120V photocell

## WPMV 3L W Y - UNV1 - S891 PC1

### Light source/intensity

<b>3L</b>	3,400 nominal lumens
<b>5L</b>	5,200 nominal lumens
<b>7L</b>	6,800 nominal lumens

### Color temperature

<b>BLANK</b>	Cool (5000K)
<b>N*</b>	Neutral (4000K)
<b>W</b>	Warm (3000K)

\*Consult factory for availability.

### Optics

<b>BLANK</b>	Wide
<b>R5</b>	Narrow

### Mounting

<b>BLANK</b>	Wall
<b>H</b>	Hub
<b>Y</b>	Yoke

### Voltage

<b>-UNV1</b>	120-277 VAC, 50/60 Hz; 125, 250VDC
<b>-UNV34</b>	347-480 VAC, 50/60 Hz

### Window material

<b>BLANK</b>	Clear glass
<b>S891</b>	Diffused glass
<b>S903</b>	Clear polycarbonate
<b>S903D</b>	Diffused polycarbonate

### Photocell

<b>PC1</b>	120V
<b>PC2</b>	208-277V

## Dimensions

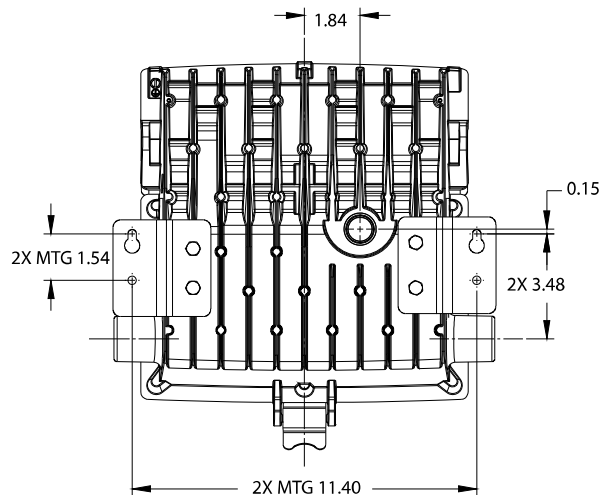
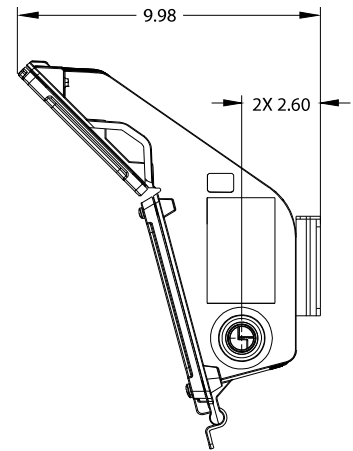
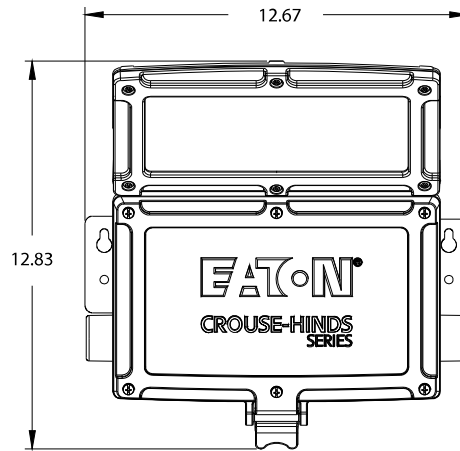
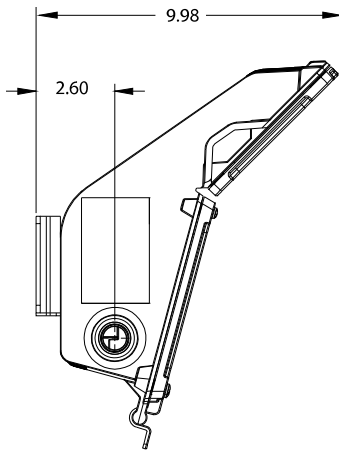

# Champ® Pro PLLA Series Linear LED Luminares

Champ Pro PLLA linear LED luminaires are designed to replace fluorescent T12, T8 and T5HO lighting in heavy and harsh industrial applications. Available in 2 foot and 4 foot versions with 3,900 lumens and 7,900 lumens respectively, the PLLA features a rugged and durable design with the industry's most versatile and flexible mounting options.

The PLLA LED stands up to high vibration, hose down, shock and impact, while delivering long life and high lumen performance for up to 20 years.

- Ideal for a variety of rugged industrial applications such as mining, food processing, marine, waste water treatment, heavy manufacturing and general wash down areas



## Key design features and benefits:

- High efficacy: up to 132 LPW
- 60,000 hour lifetime @ 65°C ambient
- -40°C to +65°C ambient operating temperature
- Ultra slim profile: 2.7" height (excluding mounting brackets). Perfect for confined or low height areas
- Wide (120°) and narrow (80°) beam optics for uniform illumination
- Vibration-, impact- and shock-resistant. 2,000 psi high pressure hose rated
- Versatile ceiling/swivel, wall, flush, pole and pendant mounting options
- Four points of secondary retention and through feed wiring options
- Surge protection: 4kV line to line, 6kV line to earth
- Emergency battery back-up (90 minutes) and surge protection options (up to 10kV)† with PLL models
- 5-year fixture warranty - refer to the authorized distributor price book for Crouse-Hinds standard terms and conditions

## Certifications:

### NEC/CEC standards:

- Type 4X
- IP66
- Wet Locations

### UL standards:

- UL1598 Luminaire
- UL1598A Luminaire for Installation on Marine Vessels

### CSA standard:

- C22.2 No. 250

### Additional standards:

- ABS design assessed

Model	Typical lumens	Wattage	Lumens per watt	Equivalent HID luminaire	Typical energy savings / lifetime
PLLA2	3,700	28.4	130	T12HO	Up to 63%
				T8HO	Up to 59%
				T5HO	Up to 47%
				T12	Up to 36%
				T8	Up to 25%
				T5	Up to 9%
PLLA4	7,900	59.8	132	T12HO	Up to 58%
				T8HO	Up to 54%
				T5HO	Up to 43%
				T12	Up to 37%
				T8	Up to 22%
				T5	Up to 10%







# Pauluhn® APEX Series Linear LED Luminaires

Crouse-Hinds series Pauluhn Apex linear LED light fixtures replace fluorescent T12, T8 and T5HO luminaires in food processing, hose down and corrosive environments.

The APEX LED was designed with food and beverage processing facilities in mind. The fixture housing is angled to mitigate debris build-up and features a food rated epoxy powder coat finish. Plus, its robust design can withstand 1,500 PSI hose pressure for wash down applications.

Three models of the APEX are available, from 13,000 to 25,000 lumens.

- Food and beverage, pharmaceutical and agriculture processing facilities.
- High pressure wash down and corrosive environments

### Key design features and benefits:

- 100+ lumens per watt provides highly efficient lighting
- Rated life is up to 60,000 hours of maintenance-free and safe operation
- Type 6061 aluminum housing with epoxy powder coat for protection against corrosion
- Angled light fixture mitigates debris build-up
- Dimmable and occupancy sensor configurations available to reduce energy consumption
- Available with polycarbonate or diffused polycarbonate lens
- Operating temperature: -40°C to +55°C\*
- 1,500 PSI hose down tested
- Surface mount, cable mount and threaded rod mount options with a through feed design for simplified multiple fixture wiring
- 5000K, 80 CRI
- 5-year fixture warranty - refer to the authorized distributor price book for Crouse-Hinds standard terms and conditions

\* APX25L model is 50°C maximum ambient operating temperature.

Model	Typical lumens *	Wattage	Lumens per watt	Equivalent MH luminaire	Typical energy savings / lifetime
APX13L	13,000	122	106	3-lamp T5HO	Up to 38%
APX17L	17,000	144	118	4-lamp T5HO	
APX25L	25,000	217	115	6-lamp T5HO	

\*All T5HO lamps used in comparison are 4 foot length.



13,000 & 17,000 lumen models

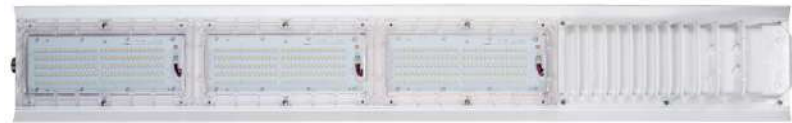

25,000 lumen model

### Certifications:

#### NEC/CEC standards:

- Type 4X
- IP66
- NSF Splash Zone

#### UL standards:

- UL1598
- UL8750

#### CSA standard:

- C22.2 No. 250



# Pauluhn® APEX LED Luminaires - Ordering Information

## Part number example

### APX13L/UNV1 S903

Pauluhn Apex, 13,000 lumens, cool white, 120-277VAC; 127-250 VDC, polycarbonate lens

## APX

#### Series

<b>APX</b>	Pauluhn Apex for non-hazardous food processing locations
------------	--

## 13L

#### Lumens

<b>13L</b>	13,000 lumens
<b>17L</b>	17,000 lumens
<b>25L</b>	25,000 lumens

## /UNV1

#### Voltage at 50/60 Hz

<b>/UNV1</b>	120-277 VAC; 127-250 VDC
<b>/UNV34</b>	347-480 VAC

## S903

#### Lenses

<b>S903</b>	Polycarbonate lens
<b>S903D</b>	Diffused polycarbonate lens

#### Accessories (ordered separately)

<b>APX1093MTK</b>	Jack chain/aircraft cable bracket
<b>APX1097MTK</b>	Adjustable surface mount bracket
<b>W3</b>	3 ft. #16/3 cord (WP163SR-3); change suffix "3" for longer cord
<b>Q</b>	Quick disconnect receptacle (WP003MR)
<b>WP163FP-6</b>	Cord assembly, molded plug and 6 ft. of #16/3 cable (WP163FP); change suffix "6" for longer cord

## Dimensions

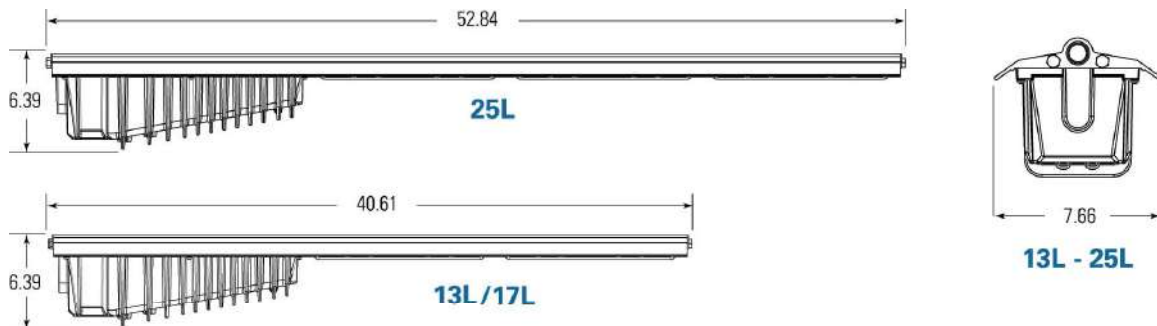

## Mounting

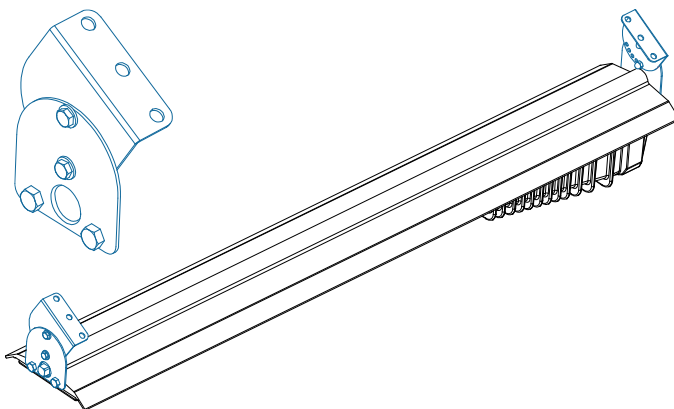

#### Adjustable surface mount

### APX1097MTK

Standard adjustable surface mounting kit includes:

- (2) 304 SS brackets and 316 SS mounting hardware

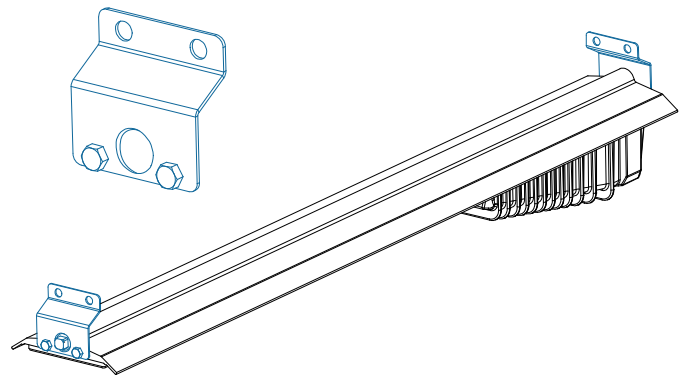

#### Chain mount

### APX1093MTK

Standard jack chain/aircraft cable mounting kit includes:

- (2) 304 SS brackets and 316 SS mounting hardware

# Vaporgard™ Pro P2L/P3L Series LED Luminaires

Vaporgard Pro LED luminaires provide uniform, crisp light and are suitable for lower mounting heights and areas or equipment requiring targeted illumination. Its unique domeless, low profile design is ideal for compact spaces where incandescent and HID based luminaires are too large to fit in the mechanical envelope required.

The Vaporgard LED is available in 1500 and 3300 lumen models, with color temperature options of cool white, neutral white, and warm white. Using four high power, high brightness LED arrays, this fixture delivers similar light levels to a 50W HID or 150-200W incandescent

- For use indoors or outdoors in confined spaces or low ceiling areas, such as tunnels, catwalks, utility rooms, over doorways, entries, landings, etc.
- Ideal for areas requiring shatter-protected products, such as food processing facilities

## Key design features and benefits:

- Instant illumination and re-strike
- Cold temperature operation; no warm-up time
- Lightweight, low profile and cool surface temperatures
- Heat sink designed to perform in high ambient temperatures up to +55°C and as low as -30°C
- Thick walled castings make for a tough, rugged housing that keeps the internal driver and LED temperature down
- High efficacy LEDs can save up to 90% in energy costs
- 70,000 hours rated life can provide 8 years of maintenance-free lighting
- Driver with internal fusing for branch circuit protection
- Tempered clear glass lens standard. Diffused glass lens and teflon coated lens (for increased safety in food processing facilities) available
- Shock- and vibration-resistant
- No mercury or hazardous chemicals - eliminates disposal concerns
- Installed using the same wall and ceiling mounts as incandescent Vaporgard fixtures
- 5-year fixture warranty - refer to the authorized distributor price book for Crouse-Hinds standard terms and conditions

Model	Nominal lumens	Wattage	Equivalent incandescent luminaire	Typical energy savings/lifetime
P2LM2C/UNV1	1,772	14	50W HID or 150-200W incandescent	90% energy savings and 50,000 hours of 24/7 operation!
P3LM2C/UNV1	3,335	29		



## Certifications:

- DesignLights Consortium® (*pending*)

## NEC and CEC

- Wet Locations, Type 4X, IP66

## UL Standards

- UL1598 Luminaires, UL1598A Marine

## CSA Standard

- cUL Listed to CSA Standard CSA C22.2 No. 250

## IEC Standard

- CE





# Vaporgard™ Pro P2L/P3L LED Luminaires - Ordering Information

## Part number example

### P2LM2CHBF1/UNV1 S891

Vaporgard LED, rated for harsh/heavy industrial areas, 1,500 lumens, Cool white (5000K), 70 CRI, wall mount with junction box, 120-277 VAC, 50/60 Hz, diffused glass lens

P	2LM2	C	HBF	1	/	UNV1	S891
<b>Series</b>		<b>Mounting modules</b>		<b>Hub size</b>		<b>Options</b>	
<b>P</b> Harsh/heavy industrial areas		<b>BLANK</b> LED housing only (warehouse/spare parts)		<b>BLANK</b> No hub (LED housing, adapter)		<b>BLANK</b> Clear glass lens	
		<b>HBF</b> VXT – wall mount with VXFT junction box		<b>1</b> ½" NPT (pendant, ceiling, wall)		<b>S891</b> Diffused glass lens	
		<b>A</b> VLA – pendant mount		<b>2</b> ¾" NPT (pendant, ceiling, wall)		<b>S896</b> Teflon coated lens	
		<b>HJ</b> VXJ – stanchion mount		<b>3</b> 1" NPT (pendant)		<b>S903</b> Clear polycarbonate lens	
		<b>HW*</b> VXW – wall mount		<b>4</b> 1-¼" NPT (stanchion)			
		<b>HF</b> VXF – junction box for ceiling mount					
		<b>HR*</b> VLHR – adapter cover (for retrofit)					
		<b>HT</b> VXT – wall mount					
<b>Lumen level (nominal)</b>						<b>Voltage</b>	
<b>2LM2</b> 1,772 lumen LED						<b>UNV1</b> 120-277 VAC, 50/60 Hz;	
<b>3LM2</b> 3,335 lumen LED						<b>DC1*</b> 10-30 VDC	
<b>Color temperature</b>							
<b>C</b> Cool (5000K), 70 CRI min.							
<b>N</b> Neutral (4000K), 80 CRI min.							
<b>W</b> Warm (3000K), 80 CRI min.							

\*Mounts directly to the wall, no VXFT junction box needed.

\*Consult factory for availability on neutral color temperature.

## CASE STUDY - Mining shovel retrofit

**Challenge:** A copper mine runs P&H 2300 electric shovels 24 hours a day, 365 days a year and at a cost of \$12,500 per hour. Each shovel has 10-16 luminaires; ~6 above the tracks for visibility of potential material obstructions and ~8-10 inside the interior for walkways, safety lighting and general illumination.

**Problem:** Current lighting on shovel is incandescent

- Lamps need replacing every 1-2 weeks due to excessive vibration on equipment and can take up to an hour to replace
- Lumen output is low and creates poor visibility in critical areas both inside and outside the shovel due to inadequate lighting.

**Solution:** Vaporgard™ LED Series Luminaires; ceiling mount (P2LCHF2/DC) for inside and above the tracks and wall mount (P2LCHT2/DC) for service areas.

**Benefit:** Vaporgard LEDs essentially eliminated lamp maintenance and saved over \$1M in downtime

- First shovel outfitted has operated without fixture failure for over 15 months
- Plant maintenance took lamp replacement off of the PM list
- Fixtures paid for themselves in roughly 3 months due to maintenance free operation



# Specification and Support Services

Eaton's Crouse-Hinds Series offers a suite of specification support tools that help simplify, streamline and speed up the industrial design and specification process. From lighting designs and drawing support tools to ROI calculators, submittal sheets and spec forms, Eaton has you covered in virtually every aspect of the process.

## CoSPEC 3D Drawing and Design

The CoSPEC Online 3D Drawing Catalog gives you the ability to select and view Crouse-Hinds products in 2D and 3D formats. Then, with just a few clicks, you can download design content and parametric data in one of nearly 100 file formats. File format outputs are native to the selected software, which eliminates translation errors and speeds the integration of content into your project. Combine this handy tool with our SKU-level Submittal Sheets for extra convenience.

Assembly PN: **VMV7L2A/UNV1**

### Configuration Options

#### Mounting Style

Pendant Mount

#### Lamp

7L - (7404 Lumens)

#### Hub Size

3/4"

#### Color Temperature

5600K (cool white)

#### Optics

Type V

#### Guard

No Guard

#### Voltage

120-277 VAC, 50/60 Hz

#### Options

No Options

**SELECT** - Pick products you need to download to the unit level.

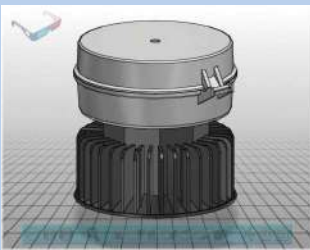

**VIEW** - View your chosen product in 2D or 3D.

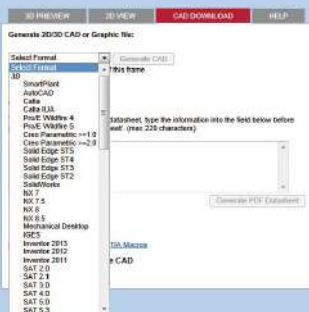

**DOWNLOAD** - Output drawing and parametric data for use on your project.



## SKU-level Submittal Sheets

These dynamic PDFs feature both SKU-level specification data and key family specs. The sheets also include a custom text area for unique data such as project name or fixture type, as well as an embedded 3D drawing.

For more information on our specification and support services, please visit [www.crouse-hinds.com/cospec](http://www.crouse-hinds.com/cospec)

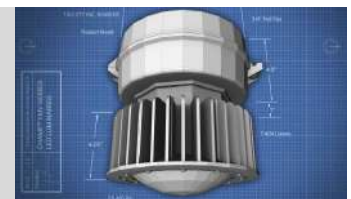

# Convenient resources for engineers, designers and drafters

## Lighting Layouts

From simple layouts to complex drawings, our lighting design engineers deliver precise, efficient, application and environment-appropriate lighting designs. Our experts can save you time and money by creating a virtual model of a proposed design, revealing luminaire characteristics and effects within the installation.

- 3D fixture placement with access to alternate fixtures and mounting heights
- Point-by-point footcandle diagram calculations
- AutoCAD®-generated floor plan overlays
- Complete bill of material

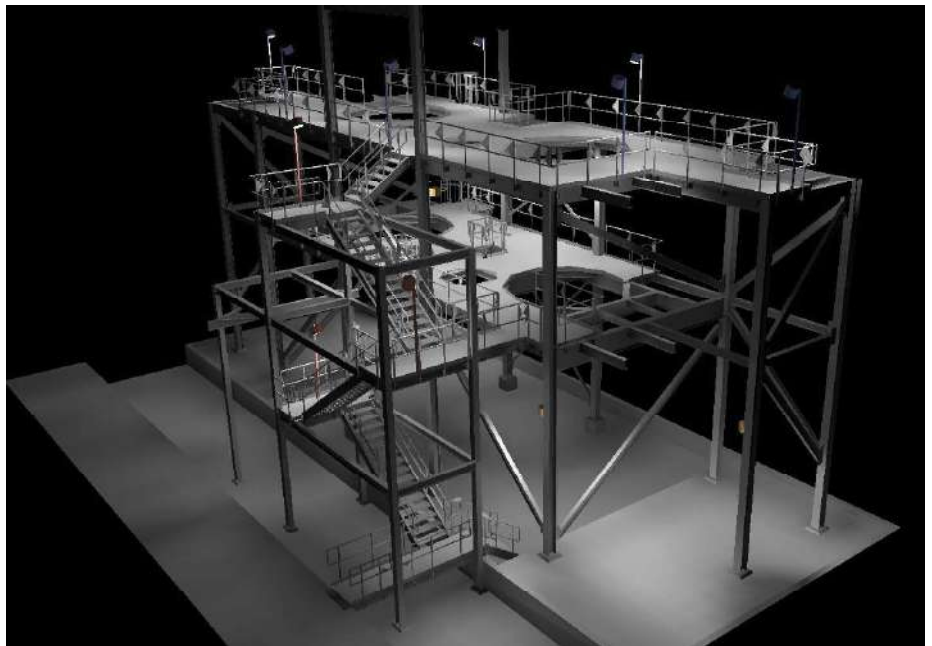

Energy Savings & Maintenance Savings			Total Cost of Ownership Comparison	
Total Cost of Ownership			Total Savings	
	400W MH	LED System		LED System
Initial investment:	\$80,000.00	\$150,000.00	Energy savings	\$1,343,520.00
Utility rebate	\$0.00	(\$0.00)	Labor & material savings	\$549,818.18
Tax rebate	\$0.00	(\$0.00)	Total savings	\$1,893,338.18
Net investment:	\$80,000.00	\$150,000.00	Initial investment	(\$150,000.00)
Total energy costs	\$1,952,640.00	\$609,120.00	Estimated Utility Rebate	\$0.00
Incremental Air Cooling Energy Costs	\$0.00	\$0.00	Estimated Tax Rebate	\$0.00
Total labor costs	\$549,818.18	\$0.00	Total return	\$1,743,338.18
Total cost of ownership	\$2,582,458.18	\$759,120.00		

Payback Period on the Incremental LED Cost (years): 0.5

Payback period on the entire LED installation (years): 1.0

## ROI Calculators

Use our interactive online cost calculators to determine how much you or your clients will save with LED luminaires from Eaton's Crouse-Hinds Business. These handy, intuitive calculators allow you to enter design parameters unique to a project and view the specific savings and payback period realized.

PRODUCT SPECIFICATION GUIDE – LED LUMINAIRES – CHAMP VMV LED SERIES	
SECTION 26 54 00 – CLASSIFIED LOCATION LIGHTING	
Product Specification Guide – Champ® LED VMV Luminaires Hi-Lumen	
SECTION 26 54 00 – Classified Location Lighting	
<b>PART 1 GENERAL</b>	
1.01 SCOPE	
A. Furnishing, installation, and assembly of lighting fixtures for areas classified as hazardous.	
1.02 REFERENCES	
A. National Fire Protection Association (NFPA):	
1. NFPA 70	National Electrical Code (NEC)

## Specification Guide Forms

Written to CSI guidelines, our Specification Guide Forms are ideal for designers whose customers have out-of-date or incomplete spec libraries. They're a quick and easy way to optimize the safety, reliability and efficiency of your design requirements.



**U.S. (global headquarters):  
Eaton's Crouse-Hinds division**

1201 Wolf Street  
Syracuse, NY 13208

(866) 764-5454  
FAX: (315) 477-5179  
FAX Orders Only:  
(866) 653-0640

[crousecustomerctr@eaton.com](mailto:crousecustomerctr@eaton.com)

**For more information:**

If further assistance is  
required, please contact  
an authorized Eaton  
Distributor, Sales Office,  
or Customer Service  
Department.

**Canada**

Toll Free: 800-265-0502  
FAX: (800) 263-9504  
FAX Orders only: (866) 653-0645

**Mexico/Latin America/Caribbean**

52-555-804-4000  
FAX: 52-555-804-4020  
[ventascentromex@eaton.com](mailto:ventascentromex@eaton.com)

**Europe (Germany)**

49 (0) 6271 806-500  
49 (0) 6271 806-476  
[sales.CCH.de@cooperindustries.com](mailto:sales.CCH.de@cooperindustries.com)

**Middle East**

971 4 8066100  
FAX: 971 4 8894813  
[chmesales@eaton.com](mailto:chmesales@eaton.com)

**Singapore**

65-6645-9888  
FAX: 65-6297-4819  
[chsi-sales@cooperindustries.com](mailto:chsi-sales@cooperindustries.com)

**China**

86-21-2899-3600  
FAX: 86-21-2899-4055  
[cchsales@cooperindustries.com](mailto:cchsales@cooperindustries.com)

**Korea**

82-2-3484-6783  
82-2-3484-6778  
[CCHK-sales@cooperindustries.com](mailto:CCHK-sales@cooperindustries.com)

**Australia**

61-2-8787-2777  
FAX: 61-2-9609-2342  
[CEASales@cooperindustries.com](mailto:CEASales@cooperindustries.com)

**India**

91-124-4683888  
FAX: 91-124-4683899  
[cchindia@eaton.com](mailto:cchindia@eaton.com)

**Eaton**  
1000 Eaton Boulevard  
Cleveland, OH 44122  
United States  
[Eaton.com](http://Eaton.com)

© 2020 Eaton  
All Rights Reserved  
Printed in USA  
Publication No. 5238-0420  
April 2020

Eaton is a registered trademark.

All other trademarks are property  
of their respective owners.