

Fast-acting UL Class CF CUBEFuse

**Catalog symbol**

- FCF_RN

Description

The Bussmann™ series fast-acting CUBEFuse is a finger-safe, current-limiting UL Class CF branch circuit fuse. It features the smallest installed footprint of any UL Class CC, J, RK or T fuse.

Ratings

- Volts 600 Vac/dc
- Amps 1-100 A
- Interrupting rating
 - 300 kA RMS Sym (UL up to 60 A)
 - 200 kA (UL 70-100 A, CSA 1-100 A)
 - 50 kA DC

Agency information

- UL Listed Fuse: Guide JDDZ, File E4273
- CSA Certified, Class 1422- 02, File 53787
- RoHS compliant
- CE

Catalog Numbers (amp)

FCF1RN	FCF20RN	FCF45RN	FCF90RN
FCF3RN	FCF25RN	FCF50RN	FCF100RN
FCF6RN	FCF30RN	FCF60RN	
FCF10RN	FCF35RN	FCF70RN	
FCF15RN	FCF40RN	FCF80RN	

Electrical characteristics

- 4 minutes max clearing time at 200% rated current for up to 30 A fuses
- 6 minutes max clearing time at 200% rated current for 35 to 60 A fuses
- 8 minutes max clearing time at 200% rated current for 70 to 100 A fuses

Watts loss at rated current:

Fuse amps	Watts
FCF15RN	3.48
FCF30RN	5.45
FCF60RN	7.27
FCF100RN	11.50

Operating and storage temperature range:

-40°C to 80°C

Materials

- Case: glass filled PES (Polyethersulfone)
- Terminals: electroless tin plated copper alloy

Features

- The world's first finger-safe power fuse system
- Smallest installed footprint of any Class CC, J, and RK fuse
- UL Class CF meets Class J fast-acting electrical performance requirements
- Faster response to damaging faults to help reduce destructive thermal and magnetic forces
- True fast-acting fuse construction
- High interrupting rating to safely interrupt faults up to 300 kA
- No venting of arc or molten metal and gases during opening
- Low let-through currents under fault conditions

Carton quantity and weight

Amps	Qty.	Weight lbs (kg)
up to 30	12	1.39 (0.63)
35-60	12	1.42 (0.65)
70-100	6	1.74 (0.79)



Powering Business Worldwide

Dimensions — in (mm)

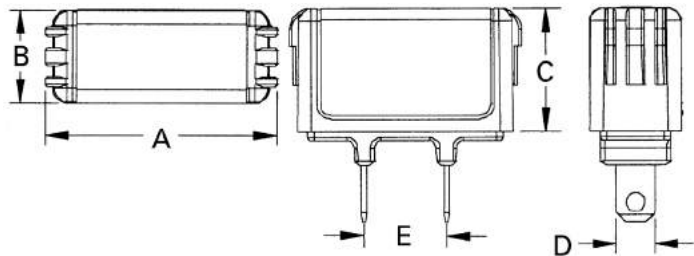

Amp range	A	B	C	D	E
1-15				0.23 (6)	
20	1.88 (48)	0.75 (19)	1.0 (25)	0.27 (7)	
25-30				0.31 (8)	0.67 (17)
35-40				0.36 (9)	
45-50	2.13 (54)		1.13 (29)	0.44 (11)	
60		1.0 (25)			
70				0.49 (12)	0.64 (16)
80-90	3.01 (76)		1.26 (32)		
100				0.57 (14)	

Current limitation curves

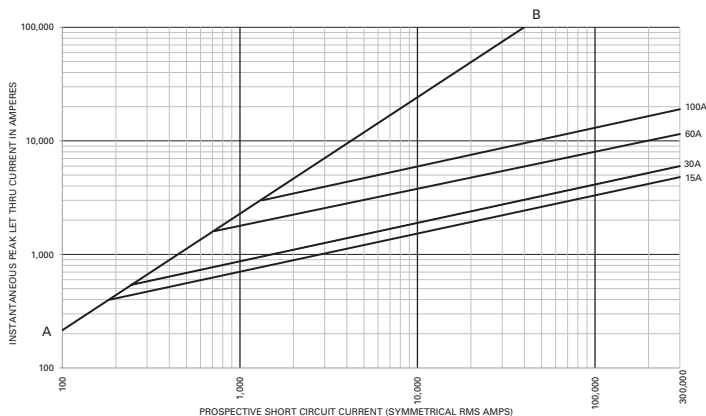

Time-current characteristic curves — average melt

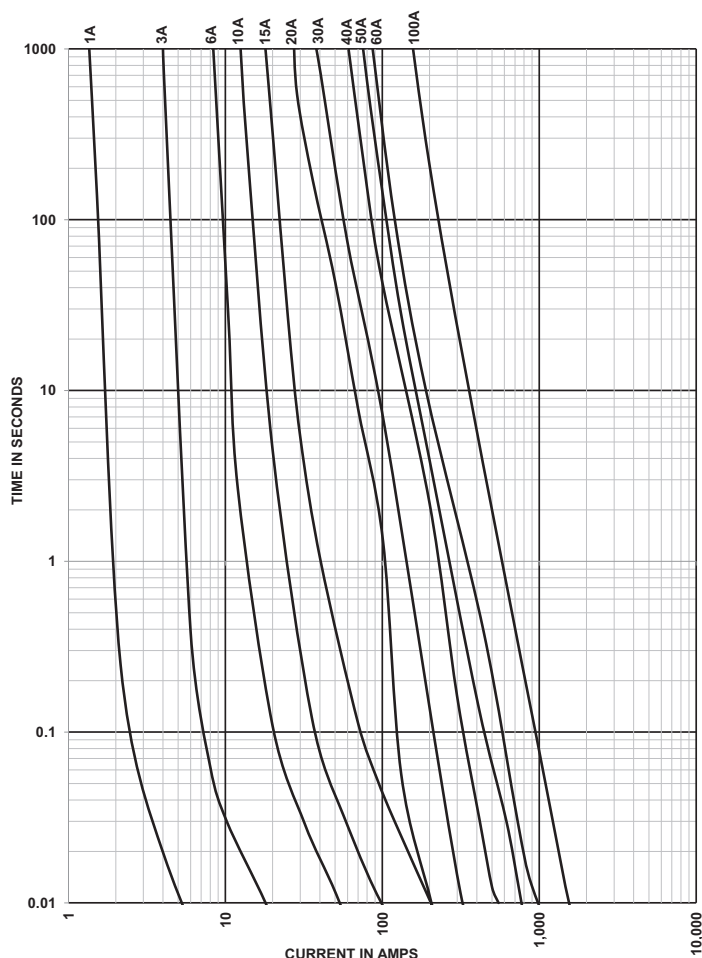

CUBEFuse holders, disconnects and panelboards

The CUBEfuse is used in the following Bussmann series products.

Description	Catalog symbol	Data sheet no.
30, 60 and 100 A holders	TCFH_N	9007
1-, 2- and 3-pole UL 98 switch	CCP2_CF	10801
1-, 2, and 3-pole panelboard switch	CCP2B	1161

The only controlled copy of this data sheet is the electronic read-only version located on the Eaton network drive. All other copies of this document are by definition uncontrolled. This bulletin is intended to clearly present comprehensive product data and provide technical information that will help the end user with design applications. Eaton reserves the right, without notice, to change design or construction of any products and to discontinue or limit distribution of any products. Eaton also reserves the right to change or update, without notice, any technical information contained in this bulletin. Once a product has been selected, it should be tested by the user in all possible applications.

Eaton
1000 Eaton Boulevard
Cleveland, OH 44122
United States
Eaton.com

Bussmann Division
114 Old State Road
Ellisville, MO 63021
United States
Eaton.com/bussmannseries

© 2018 Eaton
All Rights Reserved
Printed in USA
Publication No. 2147 - BU-SB10811
August 2018

Eaton and Bussmann are valuable trademarks of Eaton in the US and other countries. You are not permitted to use the Eaton trademarks without prior written consent of Eaton.

CSA is a registered trademark of the Canadian Standards Group
UL is a registered trademark of the Underwriters Laboratories, Inc.

For Eaton's Bussmann series product information, call 1-855-287-7626 or visit: Eaton.com/bussmannseries

Follow us on social media to get the latest product and support information.

